

SIZE		ISO-5211		a	D	C	g	t	h	n	H	P	L	M	SL	S	
INCH	MM	A	B														
6"	150	F12	125	M12	6.0	11.18	9.65	8.64	1.00	0.90	8	20.0	3.62	15.76	1.03	1.65	2.87
8"	200	F12	125	M12	8.00	13.72	11.94	10.80	1.14	0.90	8	21.6	4.0	18.28	1.27	1.66	2.63
10"	250	F14	140	M16	10.0	16.26	14.48	12.95	1.21	1.00	12	21.6	4.0	21.32	N/A	N/A	N/A
12"	300	F14	140	M16	12.0	19.32	17.28	15.24	1.27	1.00	12	N/A	N/A	24.4	N/A	N/A	N/A

DIMENSION IN INCH

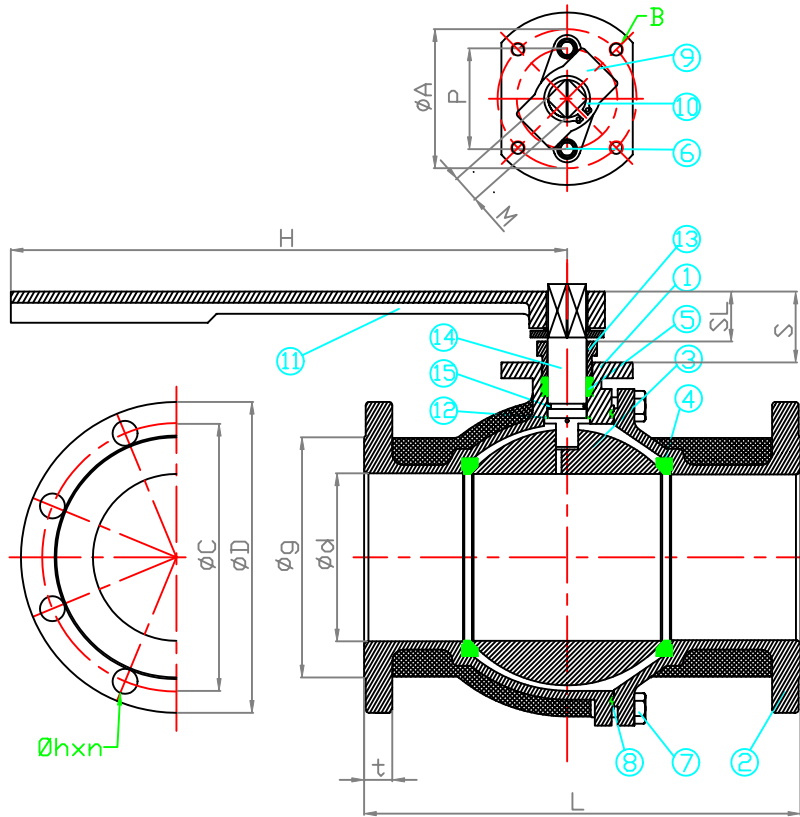

NO.	PART	MATERIAL		Q'TY
1	Body	WCB=1.0619	CF8M=1.4408	1
2	Cap	WCB=1.0619	CF8M=1.4408	2
3	Ball (Relief Hole)	CF8M=1.4408		1
4	Seat	PTFE		2
5	Stem Packing	PTFE		2~3
6	Gland Bolt	AISI304=1.4301		2
7	Hex Cap Screws	AISI304=1.4301		8~12
8	Body Seal	PTFE		1
9	Stopper	AISI304=1.4301		1
10	Retaining Ring	AISI304=1.4301		1
11	Handle	FCD-45=GGG45		1
12	Thrust Washer	PTFE		1
13	Gland	AISI304=1.4301		1
14	Stem(Antistatic element)	AISI316=1.4401		1
15	O-Ring	Viton		1

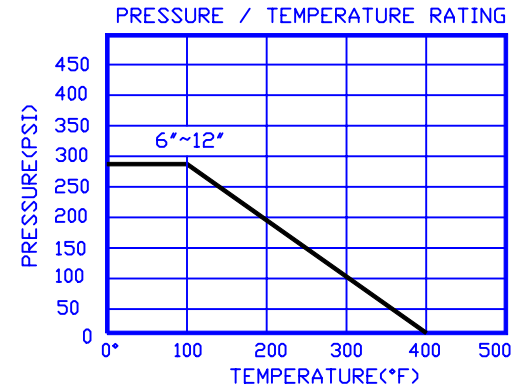

REV.	REVISION NOTE:	BY	CHK	APP	DATE (DD/MM/YR)
A	ISSUED FOR REVIEW	CW	JW	JW	25/08/04

Elite Valve Canada

PROJECT NO.		DATE (DD/MM/YR)	CLIENT	
DRAWN BY	CW	10/08/04	DRAWING TITLE	E9200(6-12in)
CHECKED BY	JW		PLOT SCALE	DWG SCALE
APPROVED BY	JW		N.T.S.	N.T.S.
PROJ. ENGR.				